

RATCHET BLOCKS

OXEN SELF-HOLDING BLOCKS

Oxen self-holding blocks offer a real advantage over blocks with cleats! Get fast, simple mainsheet (and jibsheet) control: just pull-to-cleat, then pull-to-release! Cleat or uncleat your jib or mainsheet every time without looking and from any position. Cleat from any angle or position on the boat, including the wings, even if your sheet passes over something en route. Line size: 5/16" to 3/8". Oxen blocks are easy to install and foolproof to use. Expensive, but the best is rarely cheap!

For a complete set of Oxen blocks with cars, order two each of the following: blocks, appropriate cars to fit your boat's track, stand-up springs and shackles.

OXEN SELF-HOLDING JIB/SPINNAKER BLOCK

The ultimate high tech, self-holding jib block. Optional Becket Kit converts

#05-0761 to #05-0762.

05-0761 3" Block with Pin \$219.00

05-0766 Becket Kit \$65.00



OXEN SELF-HOLDING JIB BLOCK WITH BECKET

For serious crews of cats without jib traveler cars, including P-16, N-5.5, and H-20. 3" sheave with pin and becket. No exterior cleats. Each.

05-0762 3" Block with Pin & Becket \$249.00



OXEN EXPLODED VIEW

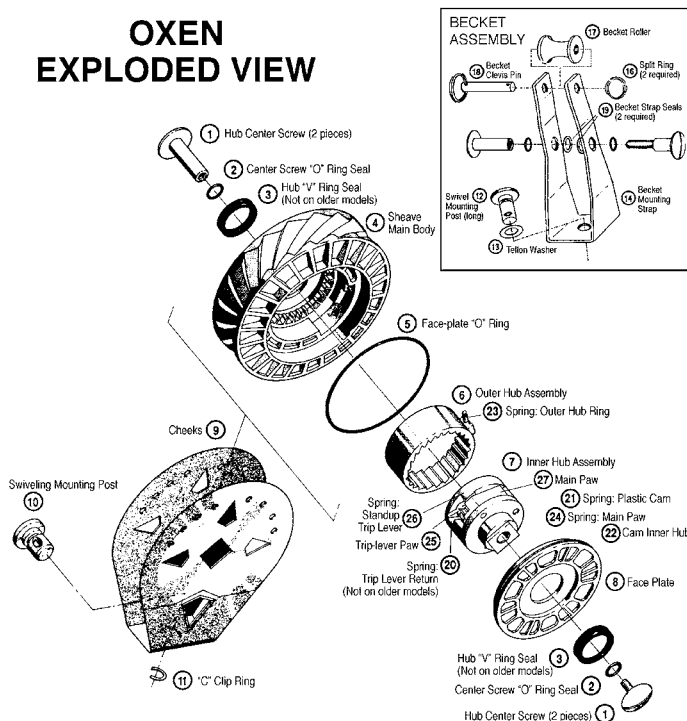

REBUILDING OXEN BLOCKS

Murrays is a complete repair facility for Oxen (aka IFL, Ochsen, Ocean) blocks. Just send us your block and we will rebuild it for an average cost of \$50.00 plus parts and shipping. Some individuals have had success repairing their own blocks, but we have had many blocks sent to us in pieces when others have failed. We regret that our technician is not available to answer rebuilding questions. This information is provided so that you can make an informed decision about the repair of your blocks.

Unfortunately, not all Oxen blocks were created equal. There have been three generations of the Inner Hub Assembly and other differences in model construction. Also, a trained technician is needed to properly adjust the spring tension which is critical and unique to each block. In addition, the wear surfaces must be within 10/1000" or there will be too much wobble and the block won't work or will soon fail.

Older Versions of the Oxen Block:

- Do not contain the "V" Ring Seals (#3) which keep water out of the unit. These blocks depend on a large amount of grease to keep water out. Needless to say, water gets in and corrosion takes place, especially on the springs which are not stainless steel.
- Cannot be retrofitted with "V" Ring Seals because the Face Plate and Main Body Sheave will not accommodate seals.
- Are lacking the Spring for the Trip Lever Paw. There is no spring and there is not even a place to put a spring. However, Murrays has constructed a special jig to update the core to accommodate the spring and we'll be happy to retrofit your Oxen block.
- Have different springs, depending on which model you have. Unfortunately, it is impossible to determine over the phone which spring you need. Just send it to us and we'll take care of it!
- Can be upgraded to be comparable to a new Oxen block, but it is necessary to replace some or all of these parts, depending on the vintage of your block:

- 1 Trip Lever Return Spring (#20)
- 1 Face Plate (#8) to accommodate the "V" Ring Seal
- 1 Main Body Sheave (#4) to accommodate the "V" Ring Seal
- 2 Hub "V" Ring Seals (#3)
- Other springs and "O" Rings as needed

OXEN REPLACEMENT PARTS

# on Diagram	Item #	Description	Price
1	05-0761-01	Hub Center Screw (2 pieces)	\$22.50
2	05-0761-02	Center Screw "O" Ring Seal	\$.75
3	05-0761-03	Hub "V" Ring Seal	\$7.00
4	05-0761-04	Sheave Main Body	\$45.00
5	05-0761-05	Face Plate "O" Ring	\$3.00
6	05-0761-06	Outer Hub Assembly	\$25.00
7	05-0761-07	Inner Hub Assembly	\$75.00
8	05-0761-08	Face Plate	\$18.00
9	05-0761-09	Cheeks	\$45.00
10	05-0761-10	Swiveling Mounting Post Short	\$7.00
11	05-0761-11	"C" Clip Ring	\$1.00
13	05-0761-13	Teflon Washer	\$.75
14	05-0761-14	Becket Mounting Strap	\$45.00
16	22-9492	Split Ring 3/16-1/4	\$.40
17	05-0761-17	Becket Roller	\$10.00
18	05-0761-18	Becket Clevis Pin	\$5.00
19	05-0761-19	Becket Strap Seal	\$.50
20	05-0761-20	Spring: Trip-Lever Return	\$2.00
21	05-0761-21	Spring: Plastic Cam	\$2.00
22	05-0761-22	Spring: Main Paw	\$2.00
23	05-0761-23	Spring: Outer Hub Ring	\$2.00
24	05-0761-24	Cam Inner Hub	\$12.00
25	05-0761-25	Trip-Lever Paw (plastic)	\$11.00
26	05-0761-26	Spring: Standup Trip Lever	\$2.00
27	05-0761-27	Main Paw	\$14.00
-	05-0761-00	Sheave Self-Locking (Complete Inner Assembly less V Ring Seals and Hub Center Screws)	\$199.00
-		Labor (includes disassembly, cleaning, lubricating and reassembly)	\$50.00

Replacement parts and rebuilding service are available for all Oxen products.

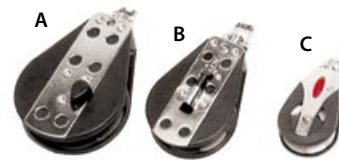

A-B. HEXARATCHET® BLOCKS

For hand-held spinnaker or small dinghy sheets. Hexaratchet® offers increased holding power without fraying the line.

- A. 28-0009 3" Single Hexaratchet® #750 SWL 7/16" line \$79.70
- B. 28-0019 2.25" Single Little Hexaratchet® #500 SWL 3/8" line \$67.30

C. SMART-RATCHET BY RONSTAN

With up to 14:1 holding power, Ronstan's Smart-Ratchet automatically engages depending on the line load, giving you precise control in changing conditions. It is load adjustable by simply rotating the head post. Ideal for spinnaker, jib and mainsheet applications on off-the-beach boats. Maximum line size 5/16"; SWL 550 lbs. 21-4210 \$77.75

57MM SINGLE CARBO RATCHAMATIC

Under low loads, this lightweight, high-strength 2-1/4" ratchet block rolls freely in both directions like a non-ratcheting block, but automatically engages the ratchet mechanism as loads increase, giving sailors an additional holding power of 10:1. 28-2625 500 SWL 3/8" line \$86.15



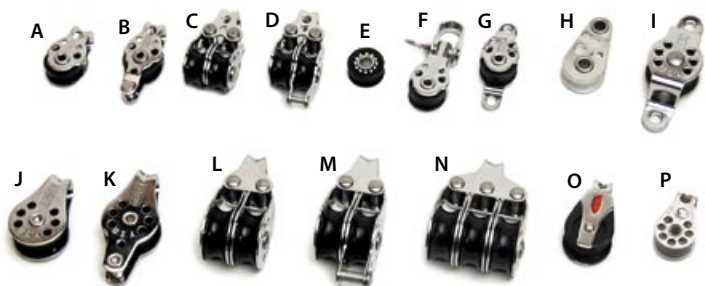

A-F. HARKEN AIR BLOCK™

Offers a very high load in an extremely light-weight block. The block itself is only 1-1/8" long. 5/8" sheave will accept line as large as 7/32". 250 lb. SWL.

- A. 28-0404 Single \$12.00
- B. 28-0405 Single with Becket \$13.75
- C. 28-0406 Double \$25.00
- D. 28-0407 Double with Becket \$27.30
- E. 28-0415 Sheave Only \$8.40
- F. 28-0417 Single with Swivel \$21.60

G-I. CHEEK BLOCKS

Downhaul and turning blocks.

- G. 28-0416 Cheek 16mm \$13.90
- H. 21-0661 Ronstan Midget (H18, Prindle) \$9.60
- I. 28-0233 Harken Micro Cheek \$13.65

RONSTAN ORBIT BULLET BLOCKS

Ronstan ball bearing Orbit Blocks™ boast the highest strength-to-weight ratio available, achieved through all-composite reinforced polymer materials and multiple attachment options.

20mm

Use the 20mm BB for control lines on catamarans and dinghies to 16 feet (5m), especially downhaul, outhaul and spinnaker halyards. Features: integrated stainless steel hub to accept lashing attachment and through-sheave becket; suits up to 4mm (5/32") lashing; high compression strength carbon Acetal sheave; stainless steel ball bearings; and nylon frame/cheeks. Specifications: 3/4" (20mm) sheave diameter; 1-1/4" long x 3/4" wide x 9/16" deep; 1/4" (6mm) maximum rope size; 550* lb. maximum working load; 1210 lb. breaking load; weighs only .3 oz. (*Block must be lashed through hub. MWL and BL are dependent on the strength of lashing. Knots, splices, stitching will generally have a lower BL than the line itself.)

- 21-25109 20mm \$11.95

30mm

Use 30mm for jib clew block. Specifications: 1-3/16" (30mm) sheave diameter; 1-7/8" long x 1-3/16" wide x 3/4" deep; 5/16" (8mm) maximum rope size; 661 lb. maximum working load; 1323 lb. breaking load; weighs .8 oz.

- 21-35101 30mm \$12.95

RELATED ITEMS

Ball Bearing Conditioner.....	pg 17
Harken Mainsheet Systems	20-21
Replacement Cleats.....	29
Rope.....	15

J-N. HARKEN MICROS

Ball bearing blocks with stainless side plates. 1/4" line. SWL: Singles 200 lbs., Doubles 350 lb., Triples 500 lbs.

- J. 28-0224 Single \$10.10
- K. 28-0225 Single with Becket \$11.60
- L. 28-0226 Double \$25.30
- M. 28-0227 Double with Becket \$27.30
- N. 28-0228 Triple \$36.15
- 28-0231 Triple with Becket & Cleat \$80.70

O. RONSTAN SINGLE MICRO

Single block has loop head and SWL of 550 lbs. Stainless steel ball bearings. 1/4" (6mm) line max.

- 21-2011 \$11.75

P. SINGLE MICRO BLOCK

Used on some Hobie jib halyards.

- 27-0153 \$9.50

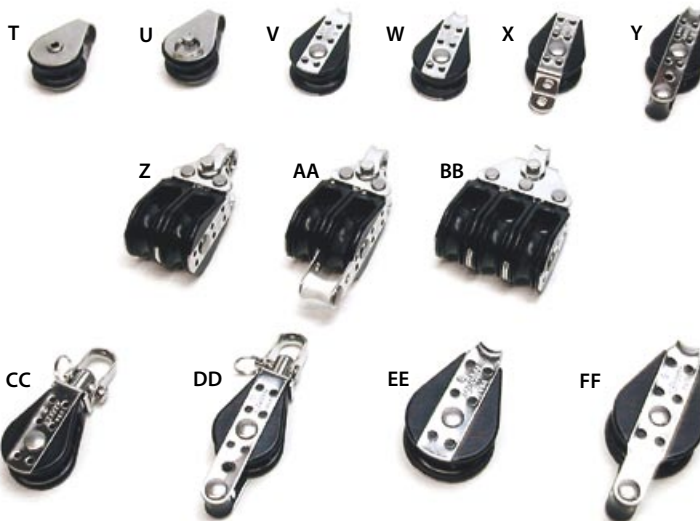

T-U. SMALL BULLET BLOCKS

1-3/16" sheave diameter. Delrin bearing. 3/8" line capacity.

- T. 23-0911 Small Bullet Block \$7.00
- U. 23-0912 Small Bullet Block with Removable Sheave \$8.50

V-EE. HARKEN BULLETS

1-1/8" sheave diameter. Delrin ball bearings. 5/16" line capacity. Maximum safe working load (SWL): Singles 300 lbs., Doubles 400 lbs., Triple and Quad 600 lbs.

- V. 28-0082 Single \$12.75
- W. 28-0098 Single (Wire) \$16.65
- X. 28-0092 Cheek \$15.50



Q-S. 29MM HARKEN CARBO BLOCKS

- Q. 28-0348 29mm Carbo Single Fixed \$12.00
- R. 28-0351 29mm Carbo Ti-Lite— Repl for Harken 82 & 125 \$19.15
- S. 28-0371 29mm Carbo Jib Clew Block Assembly \$25.60

40MM HARKEN CARBO BLOCK

Hang on the becket of any of the Harken® 6:1 base blocks to upgrade to a 7:1 system. Single/ fixed block is 2-1/2" long and can accommodate 3/8" maximum line diameter. Each.

- 28-2650 \$21.60



GG. LOOP TOP SINGLE BLOCK

Used on older Prindle trapeze return shock cord. For up to 1/4" line. SWL: 660 lbs. Wt. .5 oz.

- 21-0571 \$9.25

HH. RONSTAN SINGLE BLOCK

Replacement jib clew block for Hobies. Light-weight stainless block with ferrule has 1-1/8" x 5/8" sheave diameter, Delrin bearing and 1/2" line capacity. SWL: 950 lbs.

- 21-0469 \$16.00

II. H-16 DOWNHAUL CHEEK BLOCK

The plastic sheave degrades and breaks on older H-16 downhaul cheek blocks and the entire block must be replaced. To install, use four #19-5031 rivets and four #19-5020 sealing casings.

- 25-3340 \$16.00

JJ. WIRE JIB HALYARD BLOCK

For H-16/18. Sheave diameter is 1-1/2".

- 50-20240001 \$53.50



KK-MM. SMALL FIDDLE BLOCKS

Use: Boom vang, righting aids. 1/4" line capacity. For 3:1 or 4:1 systems, as noted. #21-0186 and #21-0188 are by Ronstan; SWL 660 lbs. #28-0245 is by Harken; SWL 350 lbs.

- KK. 21-0188 Single with Becket (3:1) \$16.00
- LL. 21-0186 Small Double Fiddle Block (4:1) \$27.60
- MM. 28-0245 Fiddle with V-Jam & Becket (4:1) \$32.20



NN-OO. MEDIUM FIDDLE BLOCKS

The price is right! Use: Boom vang, righting aids. 3/16" to 3/8" line.

- NN. 25-3901 Fiddle with Swivel 4:1 \$26.00
- OO. 25-3902 Fiddle with Cleat & Becket 4:1 \$65.00